

APLUS+ Network Conference 2024

Call for Conference Sponsors & Exhibitors



Our 21st Annual APLUS+ Network Conference

***Personalized Learning:
Where Imagination is Transforming Education***

**Deadline for Final Sponsor-Exhibitor Space Reservations:
August 15th, 2024**

**Wednesday October 23rd—Friday, October 25th, 2024
Sheraton Park Anaheim Resort Hotel
Anaheim, California**

"Personalized Learning: Where Imagination is Transforming Education"

Final Deadline for Sponsorship Reservations: August 15th, 2024

Celebrating our 21st annual conference in 2024 by returning to the pinnacle of imagination at the magic kingdom of Disneyland, we highlight this year our pioneering efforts through the Flex-Based Personalized Learning model to transform education to meet the needs, interests, and goals of all students. APLUS+ anticipates 400+ attendees at this year's 21st annual event. Sponsorships are open to current APLUS+ Preferred Partners, current APLUS+ member schools, affiliate association and organization partners, and high quality, non-member resource and service providers. Sponsors may choose from one of three conference sponsorship levels as described below.



Sponsorship Levels & Benefits

Sponsorship level differences are **highlighted in bold below**.

AAA+ (\$6,000 contribution)

- **Up to FOUR FREE conference attendee registrations.**
- **Full page COLOR advertisement priority placement on front inside cover, back inside cover, back cover, or closest location in proximity to front or back of the APLUS+ Conference Program Guide.**
- **Conference attendee contact list after registration closes and prior to conference start date.**
- **Whoa conference mobile app banner listing.**
- **NEW: FREE access to electrical convenience outlet* (*in most foyer locations for light electric load usage)**
- **FIRST** Priority primary foyer exhibit space location.
- **FIRST** Priority for scheduling for session presentation.
- **FIRST** Priority for conference program guide advertising placement.
- Sponsor logo listing on APLUS+ Conference sponsor page in APLUS+ conference program.
- Company logo printed on every APLUS+ Conference tote bag.
- Company brochures/flyers inserted into every attendee tote bag.
- Honorable mention and expression of appreciation during Conference opening session.

AA+ (\$3,000 contribution)

- **TWO FREE conference attendee registrations.**
- **Full page COLOR advertisement within APLUS+ Conference Program Guide.**
- **Whoa conference mobile app banner listing.**
- **NEW: FREE access to electrical convenience outlet* (*in most foyer locations for light electric load usage)**
- **SECOND** Priority primary foyer exhibit space location.
- **SECOND** Priority for scheduling for session presentation.
- **SECOND** Priority for conference program guide advertising placement.
- Sponsor logo listing on APLUS+ Conference sponsor page in APLUS+ Conference Program Guide.
- Company logo printed on every APLUS+ Conference tote bag.
- Company brochures/flyers inserted into every attendee tote bag.
- Honorable mention and expression of appreciation during Conference opening session.

A+ (\$1,500 contribution)

- **ONE FREE conference attendee registration.**
- **½ page COLOR advertisement within APLUS+ Conference Program Guide.**
- **FIRST** Priority Park Plaza Ballroom exhibit space location.
- **THIRD** Priority for scheduling for session presentation.
- **THIRD** Priority for conference program guide advertising placement
- Sponsor logo listing on APLUS+ Conference sponsor page in APLUS+ conference program
- Company logo printed on every APLUS+ Conference tote bag.
- Company brochures/flyers inserted into every attendee tote bag.
- Honorable mention and expression of appreciation during Conference opening session.



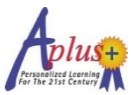

APLUS+ Conference 2024 Sponsorship Exhibit Tables/Spaces

"Personalized Learning: Where Imagination is Transforming Education"

Final Deadline for Sponsorship Reservations: August 15th, 2024

Prime APLUS+ Conference 2024 Sponsor Foyer Exhibit Spaces for APLUS+ Sponsors

Prime location 6' x 30" exhibit tables/spaces in the El Prado Foyer at the entrance to the Park Ballroom are numbered below from #F1-F20 and are reserved for APLUS+ Conference 2024 Sponsors. Due to the high demand for these prime El Prado Foyer exhibit locations, Sponsors are limited to one exhibit table/space only per sponsor. For all prime location exhibit spaces in the El Prado Foyer, assignments will be prioritized on a first come, first served basis within each designated sponsorship level first for AAA+ Level Sponsors followed by AA+ Level Sponsors and then A+ Sponsors. Sponsorship exhibit locations shall only be officially reserved once a completed Sponsor Registration Form and payment have been received. Nearly all prime sponsor exhibit spaces in the foyer (except F19, F21, F22, and F23) will be provided with FREE complimentary access to electrical outlet service for exhibit equipment with light electrical load usage only. Electrical service for F19, F21, F22, and F23 and for any sponsor exhibit space requiring heavy electrical load usage must be ordered separately through Encore directly at an additional charge. (See instructions on page 7).

APLUS+ has arranged to reserve additional secondary prime location 6' x 18" (narrower) exhibit tables/spaces for APLUS+ Conference 2024 Sponsors as needed in the left side Foyer area. These spaces are numbered below along the left side from #F21*-F26*. The asterisk (*) alongside each of these 6 exhibit spaces in the side Foyer area indicates the narrower table size (18" vs. 30") due to hotel's fire code safety regulations. Additionally, APLUS+ has just added 10 standard 6' x 30" exhibit spaces in the Park C room (PC1-PC10). See the diagram on page 4 for the exhibit spaces available in the Park C room.

El Prado Foyer Prime Sponsor Exhibit Space Diagram

All Prime Foyer Sponsorship Spaces F1-F20 Are Now Sold Out

Only the Narrower F21-F23 and F25-F26 Tables in the Foyer Side Corridor Are Currently Available

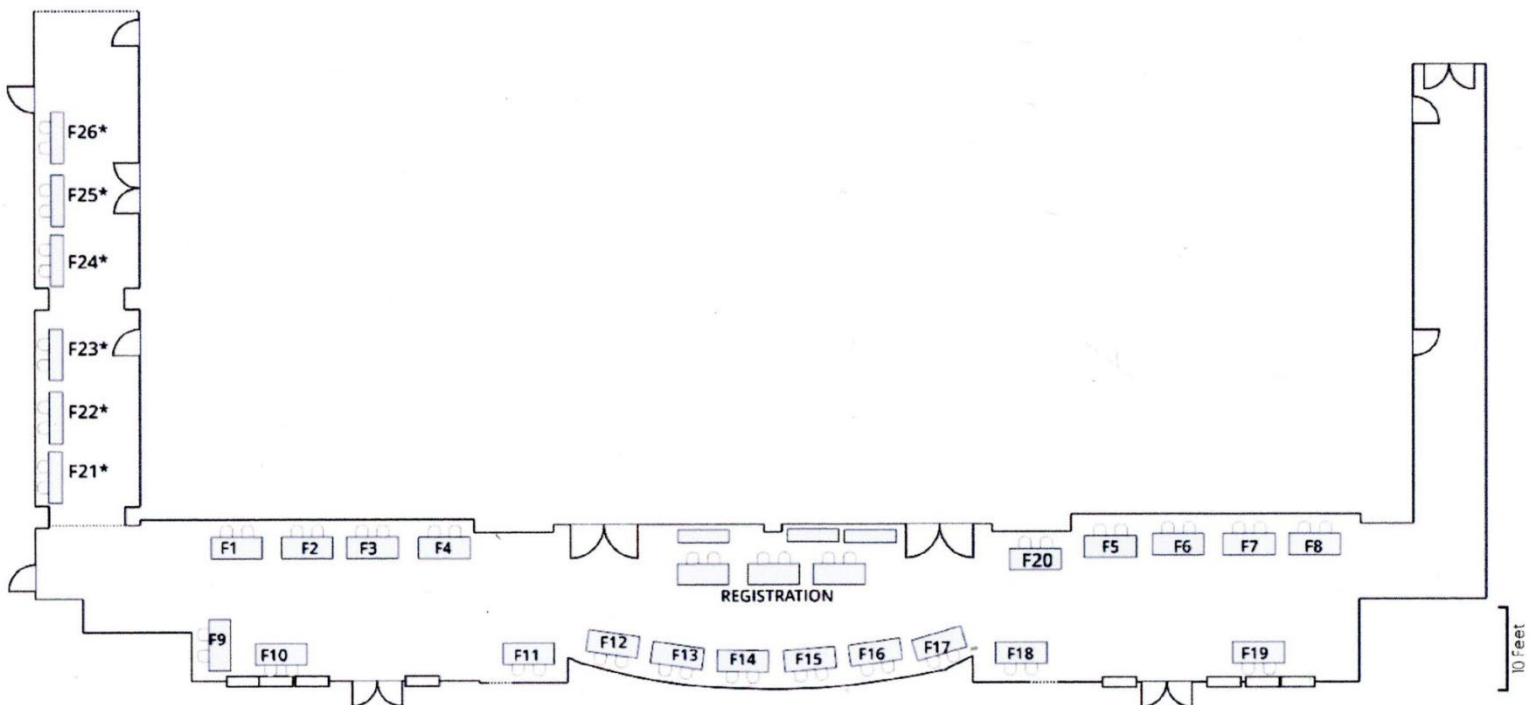

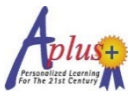

APLUS+ Conference 2024 Standard Exhibitor Tables/Spaces

"Personalized Learning: Where Imagination is Transforming Education"

Standard APLUS+ Conference 2024 Exhibit Spaces for Overflow Sponsors & Exhibitors

Standard 6' x 30" exhibit tables/spaces for APLUS+ Conference 2024 Sponsors and standard Exhibitors are located on two sides of the perimeter of the Park Ballroom as indicated below and are numbered from PB1 through PB12. Exhibit spaces numbered PB8-PB12 on the right side of the Park Ballroom will have FREE complimentary electrical access for light equipment load usage only. Electrical service for PB1-PB7 and for any exhibit space requiring heavy electrical load usage must be ordered separately through Encore directly at an additional charge. Currently, only PB1, PB2, and PB4 are available in the ballroom. APLUS+ has arranged for additional overflow sponsor/exhibitor spaces in the Park C room pictured below, which is adjacent to the main ballroom and accessible both from the ballroom and from the foyer side corridor pictured in the diagram on the previous page. All 3 remaining ballroom spaces and the 10 added sponsor/exhibitor spaces in the Park C room (designated as PC1-PC10 clockwise starting from the table immediately to the right of "Park C" below, are currently available on a first come, first serve basis.

The Park Ballroom, which is adjacent to the El Prado Foyer as pictured in the diagram on the previous page, will host our general session events and meals. During breakout session times the Park Ballroom will also be split into separate rooms for hosting some of our Wednesday workshops, and our Spotlight sessions and some of our breakout sessions on Thursday and Friday morning.

Park Ballroom and Park C Room Exhibitor Space Diagram

Only PB1, PB2, and PB4 Are Currently Available in the Main Ballroom

All Spaces in the Park C room (PC1-PC10) are currently available

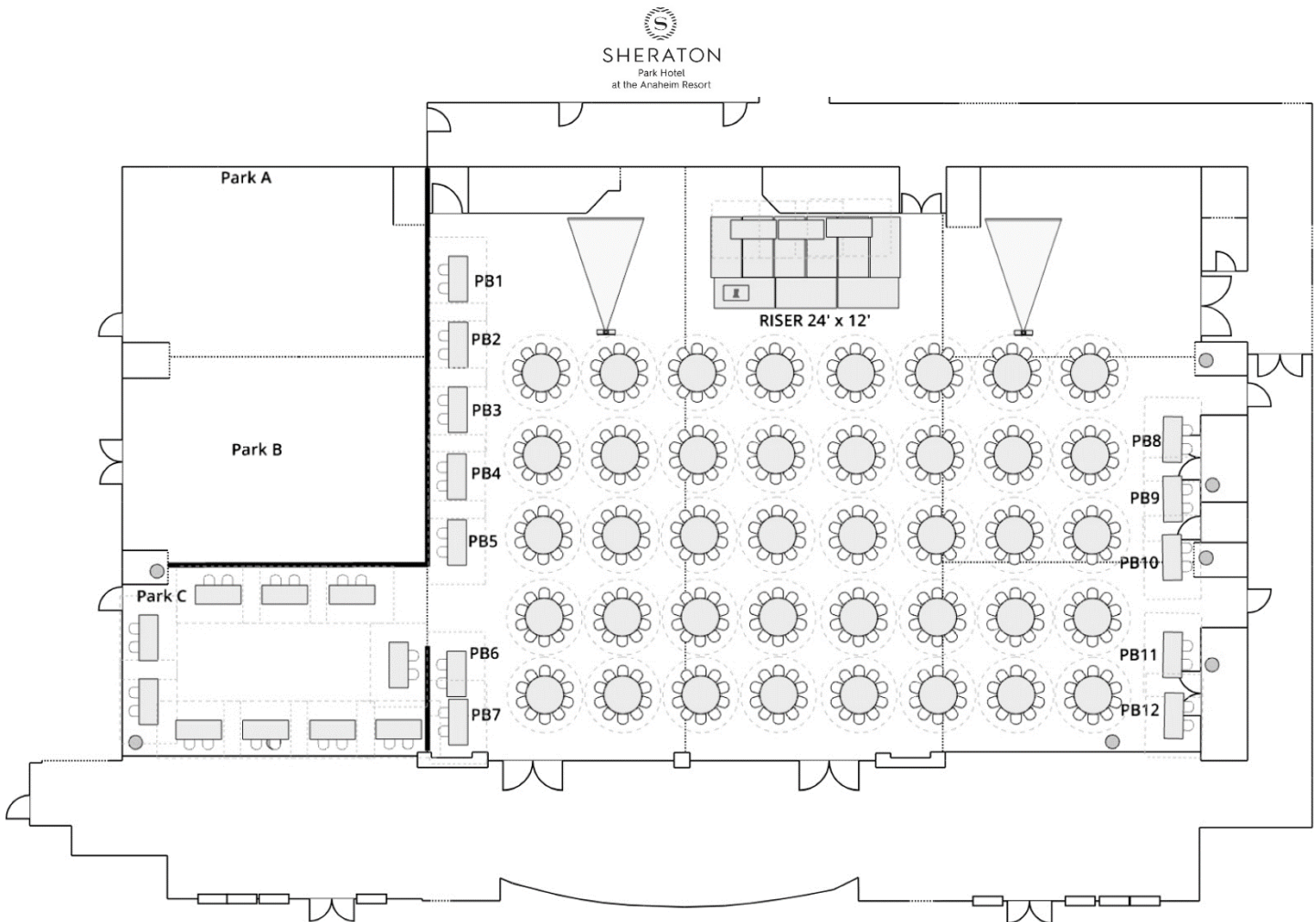

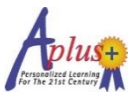

APLUS+ Conference 2024 Sponsor Registration Form

Final Sponsorship Submission Deadline is August 15th, 2024

To secure your APLUS+ Conference 2024 sponsorship space registration, please complete the sponsorship registration form below. Please note that all sponsor attendees must officially register for the conference below. Any additional attendees from the sponsor organization beyond the allotted free registrations listed on page 2 may attend at the early registration discount member rate of \$749 per person.

APLUS+ Sponsor Information:

Organization Name: _____

Contact First Name: _____ Last Name: _____ Title: _____

Contact Phone: _____ Email: _____

Please Select Your Sponsorship Level:

AAA+ (\$6000 contribution) AA+ (\$3000 contribution) A+ (\$1500 contribution)

Please Select Your Preferred Exhibit Table/Space Location (one prime table/space per sponsor only)

(See both exhibitor space layouts on pages 3 and 4):

El Prado Side Corridor Foyer: (Currently Available as of 4/26/2024)

F21*, F22*, F23*, F25* F26* (* designates narrower 6' x 18" tables/spaces due to fire code)

Park Ballroom and Park C: (Priority reservations given to overflow Conference Sponsors followed by standard APLUS+ Preferred Partners and non-member Exhibitors on a first come, first served basis):

Park Ballroom (PB): PB1, PB2, PB4; **Park C Room (PC):** PC1, PC2, PC3, PC4, PC5, PC6, PC7, PC8, PC9, PC10

(one prime foyer exhibit space per APLUS+ Sponsor only)

Top 3 sponsor space location preferences: **Choice #1**_____ **Choice #2**_____ **Choice #3**_____

Do you require access to electrical service: #Y_____ N_____ **If yes, load usage: Light Medium Heavy**

#If yes, only F25, F26, and PC1-PC3 and PC7-PC10 will have FREE access to electrical service for light load usage only.

Sponsor Attendees:

#1: First Name: _____ Last Name: _____ Title: _____ Email: _____

#2: First Name: _____ Last Name: _____ Title: _____ Email: _____

#3: First Name: _____ Last Name: _____ Title: _____ Email: _____

#4: First Name: _____ Last Name: _____ Title: _____ Email: _____

Please email this completed sponsorship form to: jeff@theaplus.org. Payment made be made either by company check or by credit card through Paypal. Please indicate your preference:

Payment by Check **Payment by Credit Card Through Paypal, Send Paypal invoice to:**

Email: _____

If paying by check, please make your check payable to APLUS+ and mail to:
APLUS+, Attn: Jeff Rice, 18820 Lodestone Court, Penn Valley, CA. 95946
For APLUS+ Conference 2024 sponsorship inquiries, please contact Jeff Rice, Founder/Director, APLUS+
Email: jeff@theaplus.org; Phone: 530-432-3609; Cell: 530-913-7693

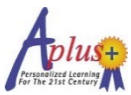

APLUS+ Conference 2024 Exhibitor Registration Form

Final Exhibitor Submission Deadline is August 15th, 2024

To secure your APLUS+ Conference 2024 exhibitor space registration, please complete the exhibitor registration form below. Please note that all exhibitor attendees must officially register for the conference. APLUS+ Preferred Partner members may attend the conference at the early registration discount member rate of \$749 per person. Non APLUS+ members attend at the standard conference rate of \$899 per person.

APLUS+ Exhibitor Information:

Organization Name: _____

Contact First Name: _____ Last Name: _____ Title: _____

Contact Phone: _____ Email: _____

Please Select Your Preferred Exhibit Table/Space Location:

(See both exhibitor space layouts on pages 3 and 4):

El Prado Side Corridor Foyer: (Currently Available as of 4/26/2024)

F21*, F22*, F23*, F25* F26* (* designates narrower 6' x 18" tables/spaces due to fire code)

Park Ballroom and Park C: (Priority reservations given to overflow Conference Sponsors followed by standard APLUS+ Preferred Partners and non-member Exhibitors on a first come, first served basis):

Park Ballroom (PB): PB1, PB2, PB4; **Park C Room (PC):** PC1, PC2, PC3, PC4, PC5, PC6, PC7, PC8, PC9, PC10

Top 3 exhibit space location preferences: **Choice #1** _____ **Choice #2** _____ **Choice #3** _____

Do you require access to electrical service: #Y _____ N _____ **If yes, load usage: Light Medium Heavy**
#If yes, only F25, F26, and PC1-PC3 and PC7-PC10 will have FREE access to electrical service for light load usage only.

Please Check One of the Following:

- Yes**, Please reserve 1 (one) 6' draped table for display
- Yes**, Please reserve 1 (one) display space for me, but I will be bringing my own portable company display
- Yes**, Please reserve an additional _____ 6' draped table(s) or space for my display for an additional \$ _____.

TOTAL # EXHIBIT TABLES/SPACES RESERVED: _____ ***TOTAL EXHIBIT TABLE/SPACE COST \$** _____

*APLUS+ Preferred Partners receive one exhibit table/space at no charge. The exhibit booth space fee for non-Preferred Partners is \$400 for one 6' table or display space, plus the cost of conference registration for each attendee at the non-member rate. Additional tables for both APLUS+ Preferred Partners and standard exhibitors are \$300 each. The APLUS+ member early registration discount rate is \$749 per person. The standard non-member registration rate is \$899 per person.

Exhibitor Attendees:

#1: First Name: _____ Last Name: _____ Title: _____ Email: _____

#2: First Name: _____ Last Name: _____ Title: _____ Email: _____

TOTAL # EXHIBITOR ATTENDEES REGISTERED: _____ **TOTAL ATTENDEE REGISTRATION COST \$** _____

TOTAL COMBINED EXHIBITOR TABLE/SPACE AND ATTENDEE REGISTRATION COST \$ _____

Please email this completed sponsorship form to: jeff@theaplus.org. Payment made be made either by company check or by credit card through Paypal. Please indicate your preference:

- Payment by Check**
- Payment by Credit Card Through Paypal, Send Paypal invoice to:**

Email: _____

If paying by check, please make your check payable to APLUS+ and mail to:
APLUS+, Attn: Jeff Rice, 18820 Lodestone Court, Penn Valley, CA. 95946
For APLUS+ Conference 2024 sponsorship inquiries, please contact Jeff Rice, Founder/Director, APLUS+
Email: jeff@theaplus.org; Phone: 530-432-3609; Cell: 530-913-7693



APLUS+ Conference 2024 Sponsor & Exhibitor Guidelines and Procedures

Exhibit Tables/Spaces:

Each APLUS+ Conference exhibitor will receive one 6' x 30" draped table with tabletop linen (or one of six 6' by 18" tables numbered F21-F26), or a six-foot wide reserved space in which to set up their own booth display. Two chairs and Wi-Fi internet access per booth/space are included standard, plus most foyer exhibit space locations for sponsors will also include, as a standard benefit, access to electrical service for equipment with light load usage. Should you require electrical service in exhibit spaces that are either not set up for complimentary light electrical load service, or for equipment with heavy electrical load usage, please see below to contact Encore directly for ordering heavy load electrical service.

Exhibit Set Up:

Exhibitor displays may be assembled beginning **after 10:00 am on Wednesday, October 23rd**. Display tables and spaces will be pre-assigned and designated with the exhibitor company name on a laminated table-top sign. Conference sponsors receive first priority for exhibit space locations.

Exhibit Hours:

Conference exhibit hours are from **7:00 am to 5:15 pm on Thursday, October 24th and 7:00 am to 12:00 noon on Friday, October 25th**.

Exhibit Break Down:

Exhibitor displays may be dismantled **after 12:00 noon on Friday, October 25th**.

Internet Access:

Wi-Fi Internet access for your exhibit is complimentary as part of your exhibit space benefits.

Sheraton Park Anaheim Hotel Special Exhibit Electrical or Equipment Needs:

The Sheraton Park Anaheim Hotel will not provide the following complimentary: Drayage and placement of display equipment; decoration and related services; guard services; labor, for carpenters, electricians, and drayage service; storage of any exhibit related materials; additional lighting and electrical power; gas or water supply; or table-top skirting. If you require special heavy load electrical needs, a/v rental equipment, or other special equipment or supplies, etc. for your exhibit, you must arrange for these items directly with Encore. Here are the instructions:

Please complete the information below:

- Show Name (as you would like to see it appear on the website):
- Expo Load In / Load Out Dates and Times:
 - In:
 - Out:
- Expo Show Start and End Dates and Times:
- Exhibitor Move In:
- Show Open:
- Exhibitor Move Out:



Encore Services Contact:

James Thornburgh, Sr. Sales Manager
E: james.thornburgh@encoreglobal.com; M: +1 714-388-8101



Sheraton Park Anaheim Hotel Shipping and Receiving Procedures:

SHERATON PARK ANAHEIM HOTEL EXHIBITOR SHIPPING & RECEIVING POLICY

Due to limitations in secured storage space, the Hotel will accept packages under the following terms and conditions:

- ◆ Boxes / packages for Exhibitors may be sent a maximum of 72 hours prior to arrival and will be marked with the Exhibitor's name, company name plus "Hold for Arrival on _____ (arrival date). The name of the function should be in a visible location on the label as well.
- ◆ Boxes / packages for Exhibitors will be subject to a handling charge, as follows. Individual exhibitors will have these charges placed on their guest room folio. Should the exhibitor not be a hotel guest, payment of these fees must be made at the Front Desk:

Boxes up to 34" x 24" x 24"	\$10.00 Per Box
Larger Boxes / Display Cases	\$20.00 Per Box
Pallets	\$200.00 Per Pallet

Additional labor charges may be incurred dependent on the size of the shipment:

- ◆ Any freight shipping charges incurred as a result of materials being shipped to or from the Hotel remain the sole responsibility of the client.
- ◆ Hotel will not be responsible for any damages or loss to any packages.